

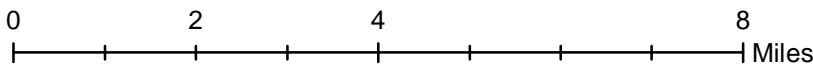

Volunteer Wildlife Monitoring Program (VWMP) Frog and Toad Survey

Route ID: 360410 Start County: Wright

Click for Google Maps to Site 1: <https://www.google.com/maps/dir/?api=1&destination=42.6875992,-93.6962967>

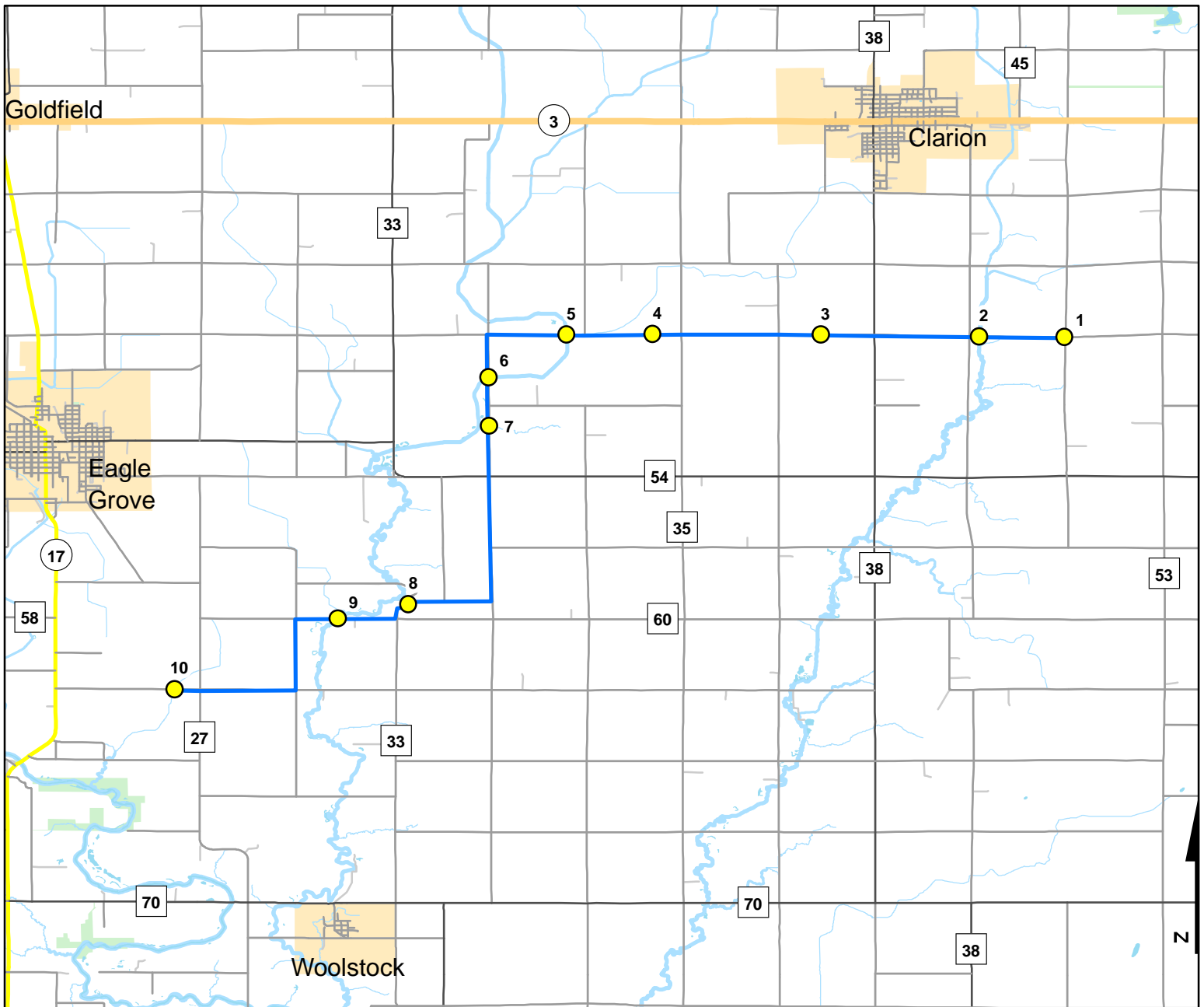

Legend

● Stop Locations

— Route Path



© OpenStreetMap (and contributors), CC-BY-SA



Volunteer Wildlife Monitoring Program (VWMP) Frog and Toad Survey

Route ID: 360410 Start County: Wright

Click for Google Maps to Site 1: <https://www.google.com/maps/dir/?api=1&destination=42.6875992,-93.6962967>

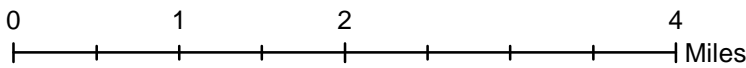
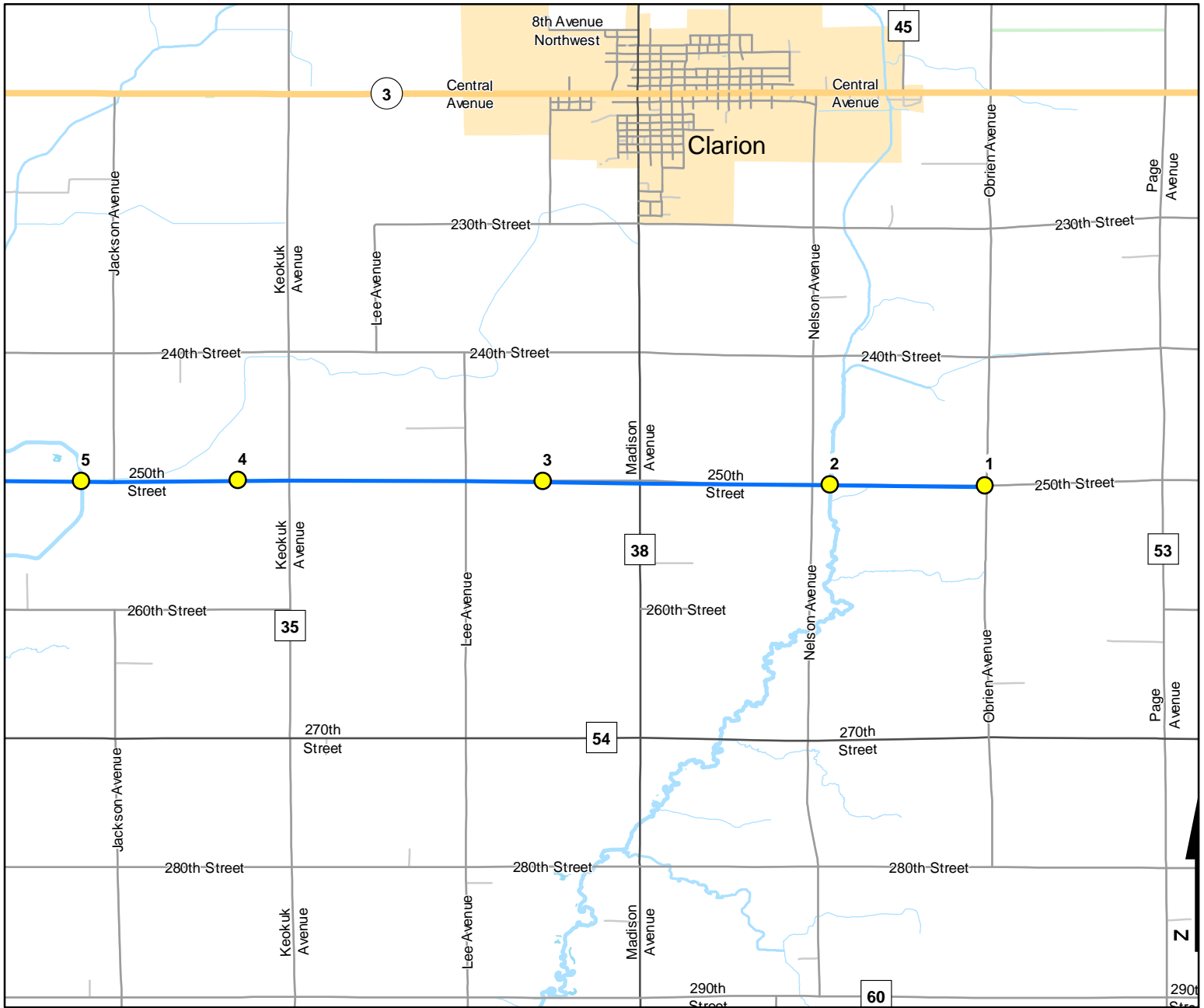

Legend

● Stop Locations

— Route Path



© OpenStreetMap (and contributors), CC-BY-SA



Volunteer Wildlife Monitoring Program (VWMP) Frog and Toad Survey

Route ID: 360410 Start County: Wright

Click for Google Maps to Site 1: <https://www.google.com/maps/dir/?api=1&destination=42.6875992,-93.6962967>

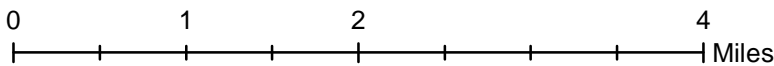
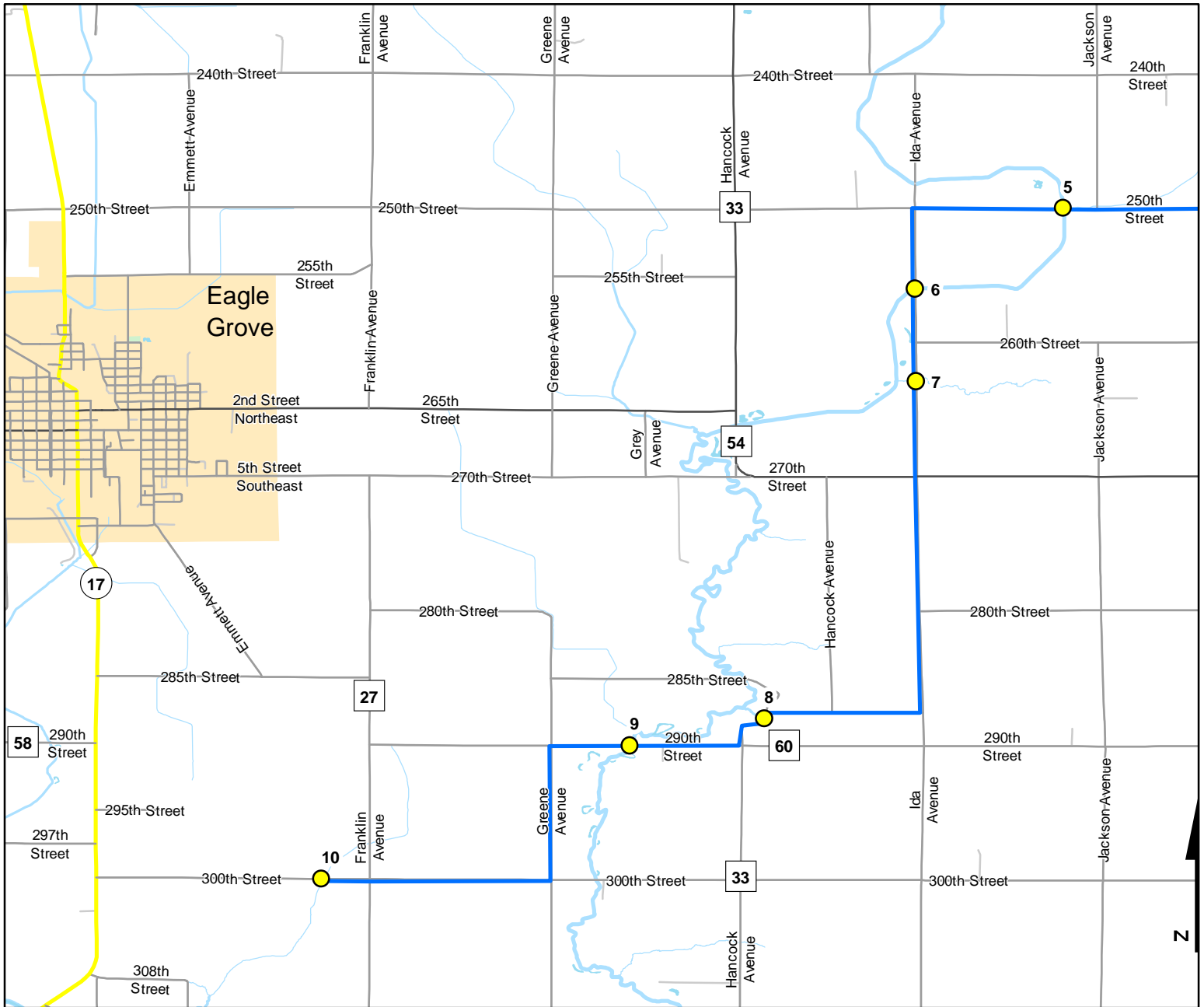

Legend

● Stop Locations

— Route Path





Frog and Toad Call Survey Route Description

Route ID **360410**

Established:

Site Number	Name	County	Latitude	Longitude	Directions
1	0	Wright	42.6875992	-93.6962967	Wet ditches on either side of the road
2	0.8	Wright	42.6876984	-93.7137985	Small stream crosses the road. Park after bridge.
3	2.5	Wright	42.6880989	-93.7461014	Wet drainage ditches on either side of the road.
4	4.2	Wright	42.6882019	-93.7804031	Small creek flowing through a drainage culvert.
5	5.1	Wright	42.6880989	-93.7979965	Large stream crosses the road. Park on or after the bridge
6	6.5	Wright	42.6794014	-93.814003	Large stream flowing perpendicular the the road. park after the bridge.
7	7.2	Wright	42.6693993	-93.8139038	A small creek runs across the road.
8	10.5	Wright	42.6329994	-93.8302994	A small creek runs on the east side of the road. There is a small pond on the west side of the road.
9	11.4	Wright	42.6301003	-93.8448029	There is a small river running across the road. Park on or after the bridge.
10	14.1	Wright	42.6156998	-93.8780975	A small creek crosses the road. Park after the narrow bridge.